

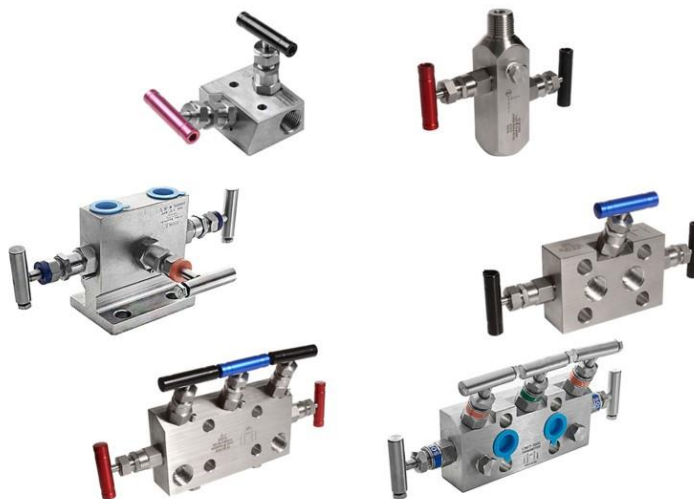

BEYOND FLUID

Beyond Fluid

Instrumentation Manifolds Valves



E-mail: sales@beyondfluid.com

Web: www.beyondfluid.com

Contents

2-valve Manifolds



02

3-valve Manifolds



09

5-valve Manifolds



13

Part Number Description

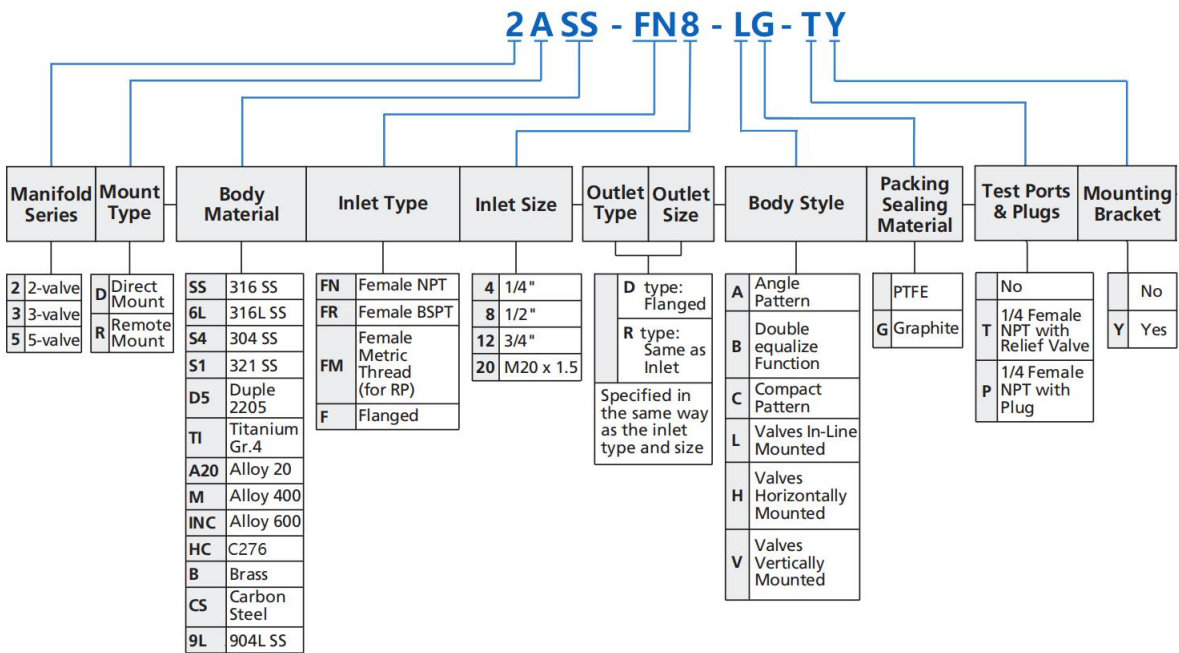

Instrumentation Manifolds

General Information

Features

- Maximum working pressure:
 - Stainless steel: up to 6000 psig (414 bar)
 - Alloy C-276: up to 6000 psig (414 bar)
 - Alloy 400: up to 5000 psig (345 bar)
- Working temperature:
 - PTFE packing: -65 F to 450 F (-54 °C to 232 °C)
 - Graphite packing: -65 F to 1200 F (-54 °C to 649 °C)
- Orifice: 0.157 (4.0 mm), CV: 0.35
- Leak-tight performance testing for every valve with nitrogen at the maximum working pressure.

Pressure vs. Temperature

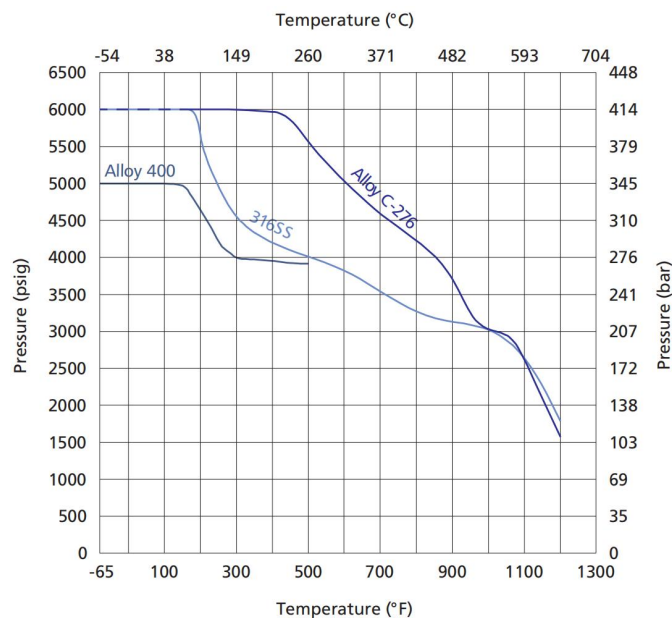

Standard Materials of Construction

NO.	Component	Material		
		316 SS	304 SS	Alloy 400
1	Handle	Anodized aluminum		
2	Set Screw	Stainless steel		
3	Packing Bolt	304 SS		
4	Upper Stem	316 SS/A276		
5	Lock Nut	304 SS		
6	Bonnet	316 SS/A276	304 SS/A276	Alloy 400/B164
7	Gland	316 SS/A276		
8	Packing	PTFE or graphite		
9	Lock Pin	316 SS/A276		
10	Lower Stem	316 SS/A276	304 SS/A276	Alloy 400/B164
11	Body	316 SS/A276	304 SS/A276	Alloy 400/B164

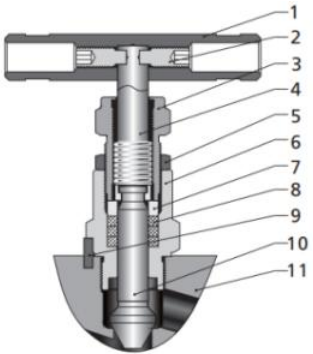

Handle color codes for functions:
 BLACK=Isolate/block
 RED=Test/vent
 GREEN=Equalize

2-valve Manifolds

Consist of one block valve and one bleed valve

Basic Ordering NO.	Inlet/Process	Outlet/Instrument	Test/vent
SS-2A1-FN8-MN8	1/2 Female NPT	1/2 Male NPT	1/4 Female NPT
SS-2A2-FN8-FN8	1/2 Female NPT	1/2 Female NPT	1/4 Female NPT
SS-2A3-MN8-FN8	1/2 Male NPT	1/2 Female NPT	1/4 Female NPT
SS-2A4-MN8-MN8	1/2 Male NPT	1/2 Male NPT	1/4 Female NPT

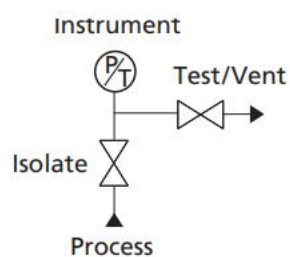
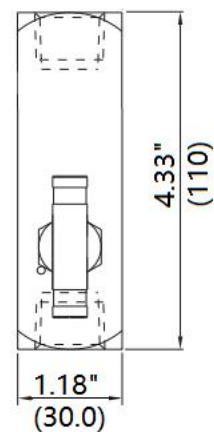
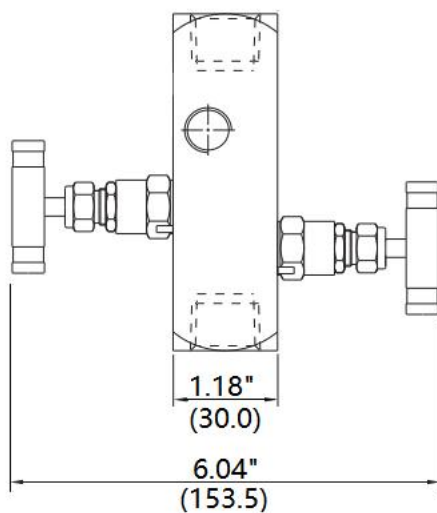
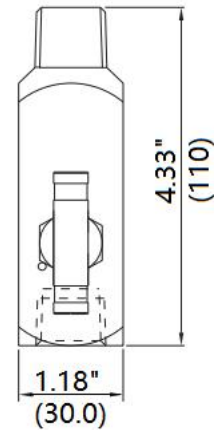
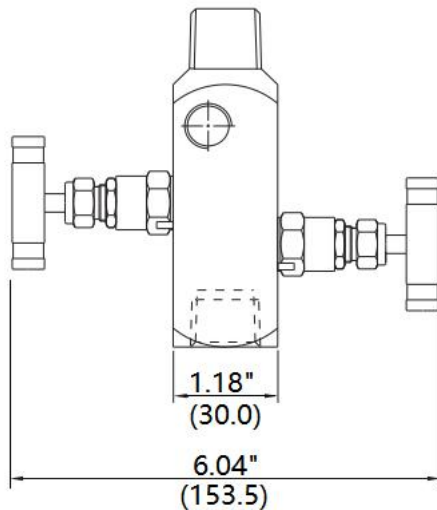

Basic Ordering NO.	Inlet/Process	Outlet/Instrument	Test/vent
SS-2B-FN8	1/2 Female NPT	1/2 Female NPT	1/4 Female NPT

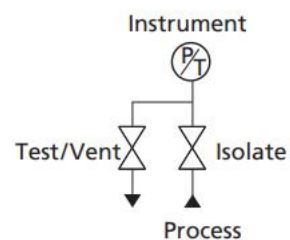
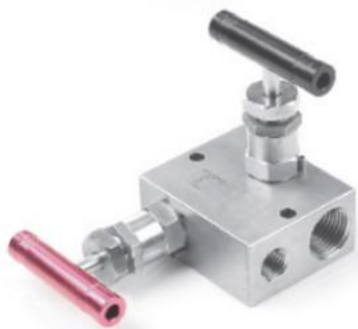
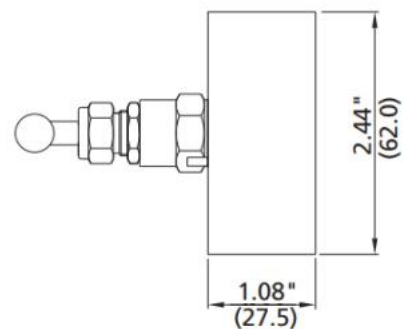
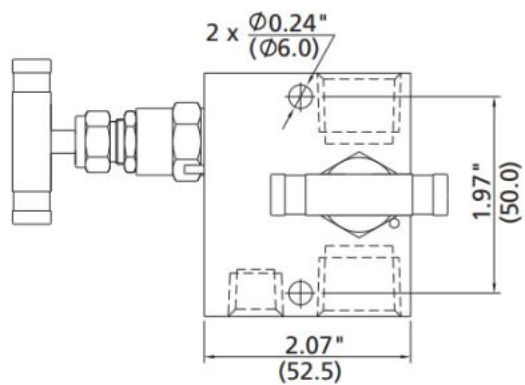

Basic Ordering NO.	Inlet/Process	Outlet/Instrument	Test/vent
SS-2C-FN8	1/2 Female NPT	1/2 Female NPT	1/4 Female NPT

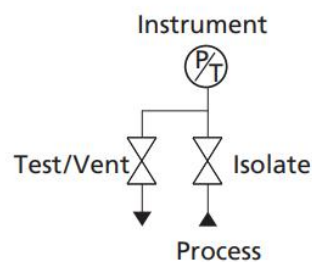
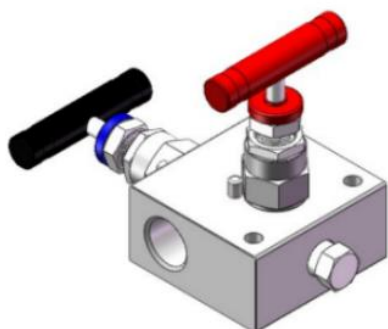
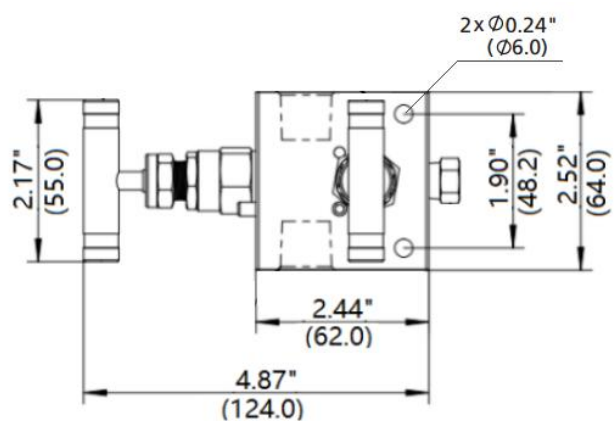
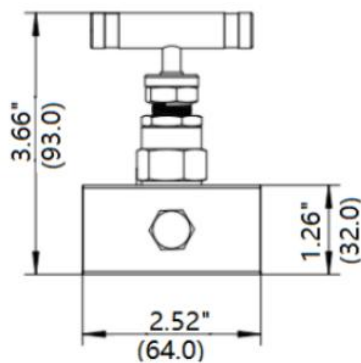

Basic Ordering NO.	Inlet/Process	Outlet/Instrument	Test/vent	Dimension, in.(mm)				
				A	H	B	C	D
SS-2D1-FN4	1/4 Female NPT	1/4 Female NPT	1/4 NPT	2.32 (58.9)	2.00 (50.8)	1.12 (28.4)	1.38 (35.0)	0.28 (7.0)
SS-2D2-FN8	1/2 Female NPT	1/2 Female NPT	1/4 NPT	2.36 (60.0)	2.44 (62.0)	1.25 (31.8)	1.61 (41.0)	0.32 (8.2)

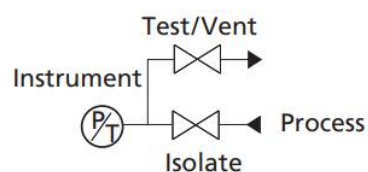
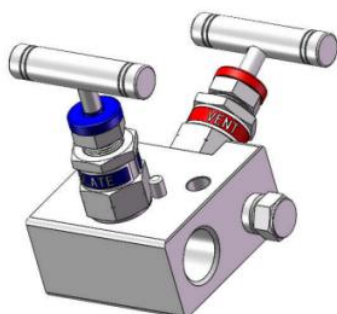
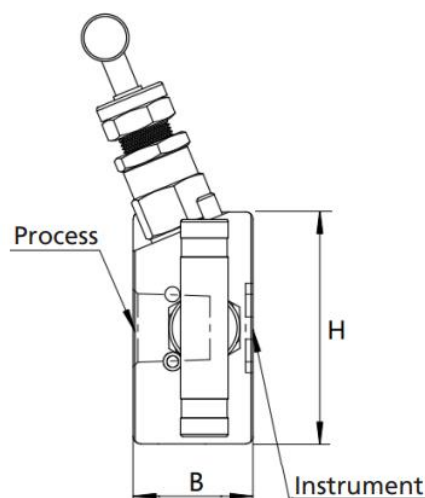
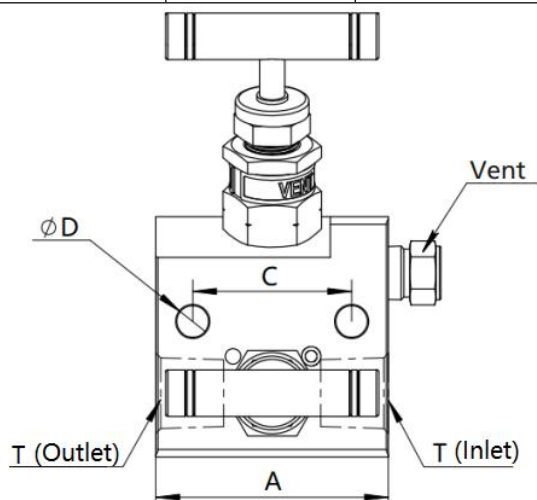

Basic Ordering NO.	Inlet/Process	Outlet/Instrument	Test/vent
SS-2E-FN8	1/2 Female NPT	1/2 Female NPT	1/4 Female NPT

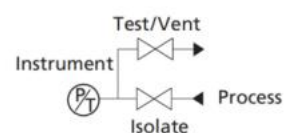
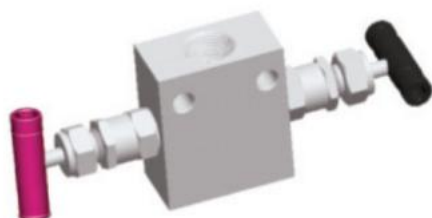
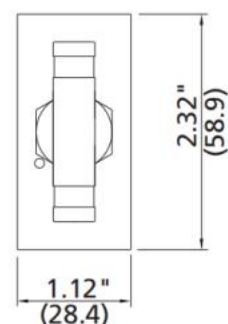
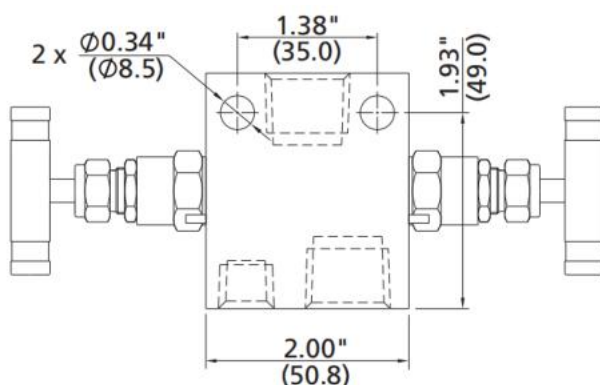

Basic Ordering NO.	Inlet/Process	Outlet/Instrument	Test/vent
SS-2F-FN8-F	1/2 Female NPT	Flange	1/4 Female NPT

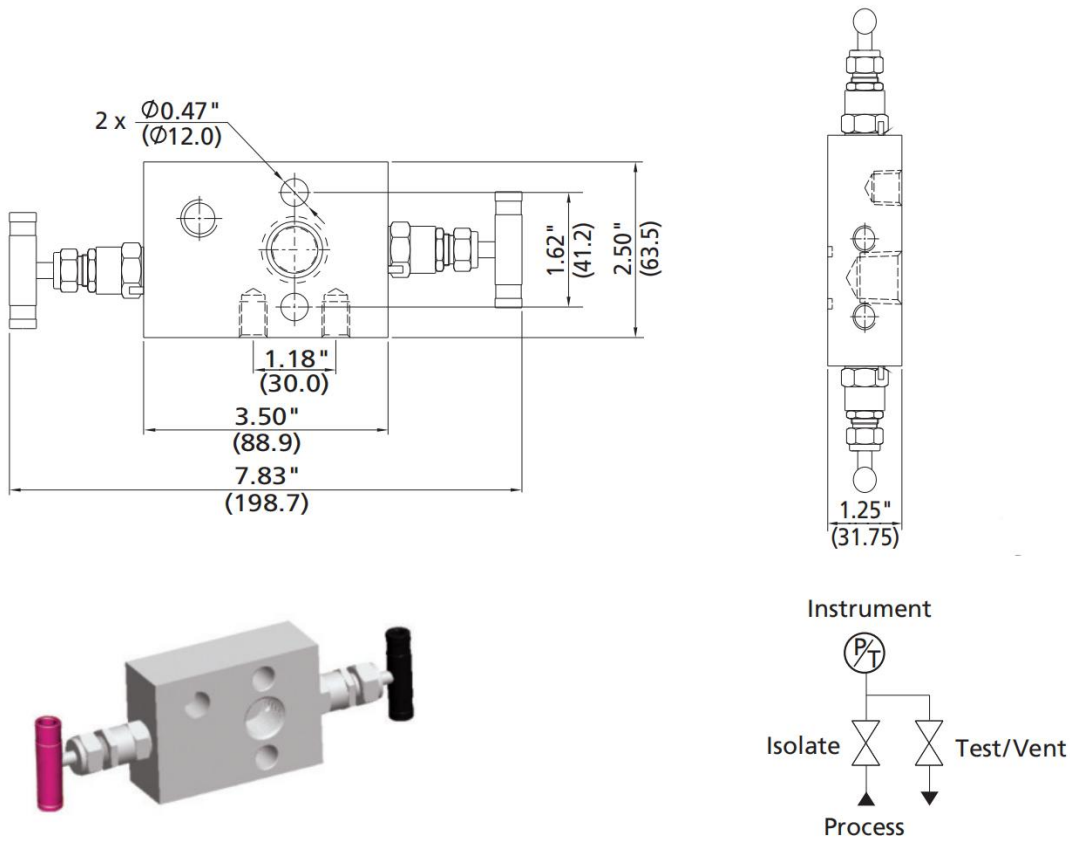

Basic Ordering NO.	Inlet/Process	Outlet/Instrument	Test/vent
SS-2G-FN8-F	1/2 Female NPT	Flange	1/4 Female NPT

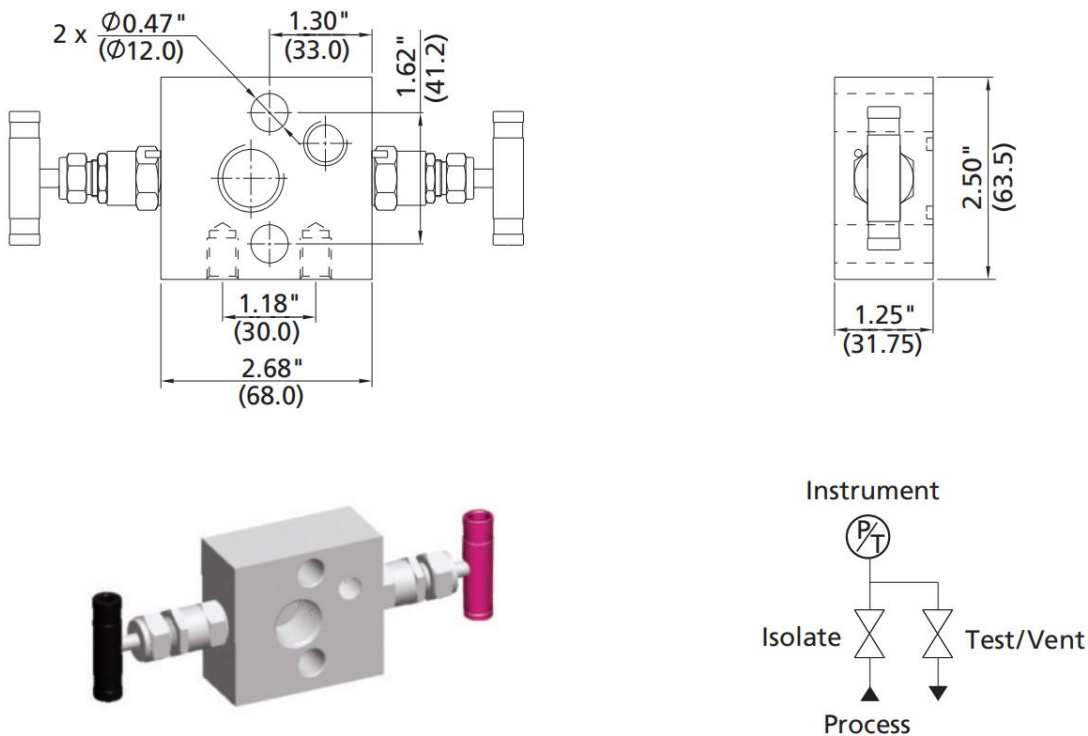

Basic Ordering NO.	Inlet/Process	Outlet/Instrument	Test/vent
SS-2H-F	Flange	Flange	1/4 Female NPT

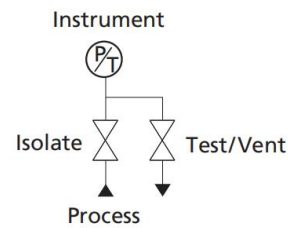
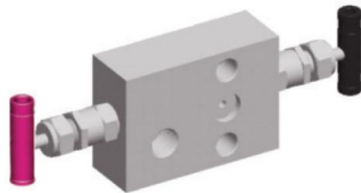
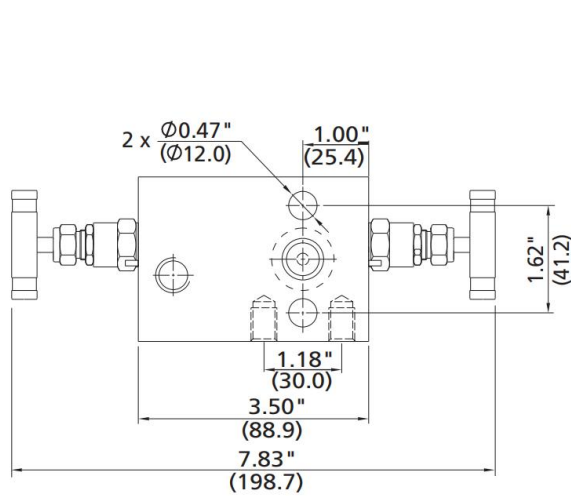

Basic Ordering NO.	Inlet/Process	Outlet/Instrument	Test/vent
SS-2J-FN8-F	1/2 Female NPT	Flange	1/4 Female NPT

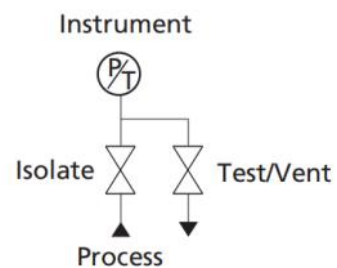
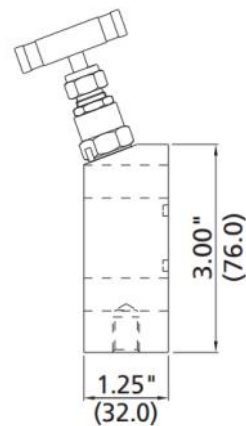
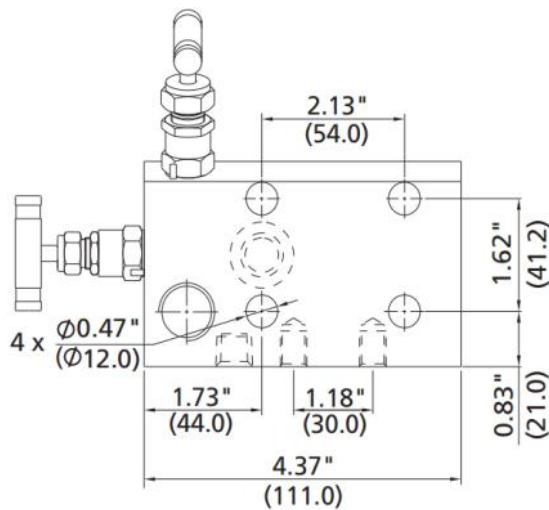

Basic Ordering NO.	Inlet/Process	Outlet/Instrument	Test/vent
SS-2K-FN8-F	1/2 Female NPT	Flange	3/8-16UNF

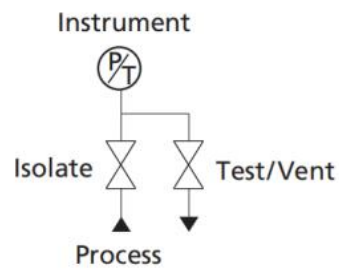
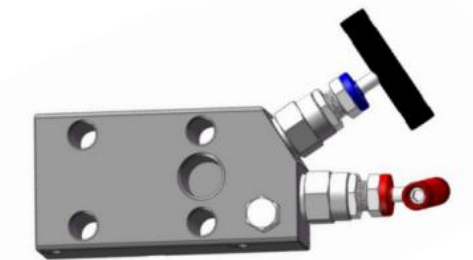
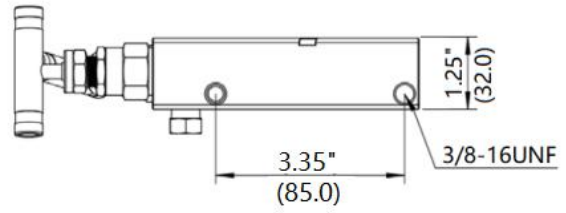
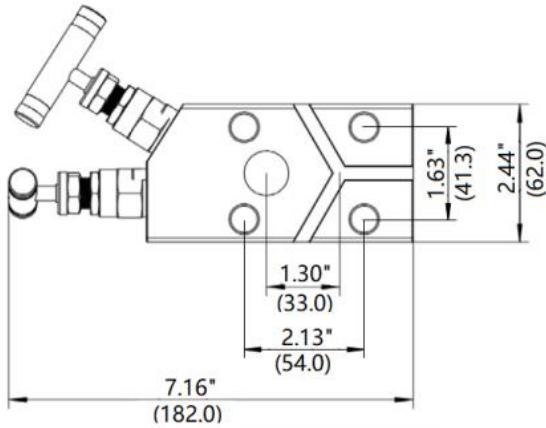

Basic Ordering NO.	Inlet/Process	Outlet/Instrument	Test/vent
SS-2L-FN8-F	1/2 Female NPT	Flange	1/4 Female NPT

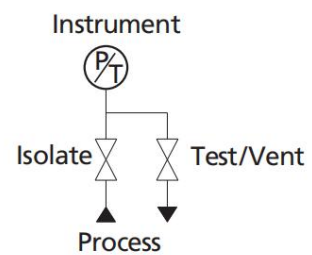
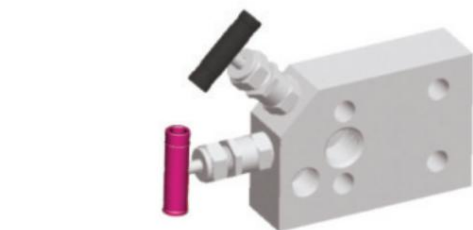
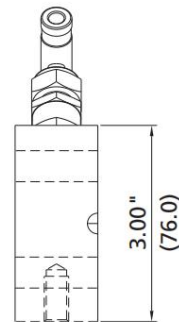
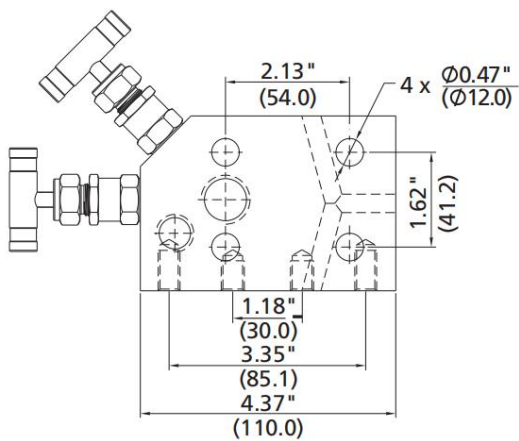

Basic Ordering NO.	Inlet/Process	Outlet/Instrument	Test/vent
SS-2M-FN8-F	1/2 Female NPT	Flange	1/4 Female NPT

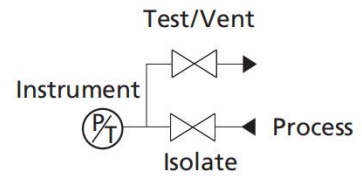
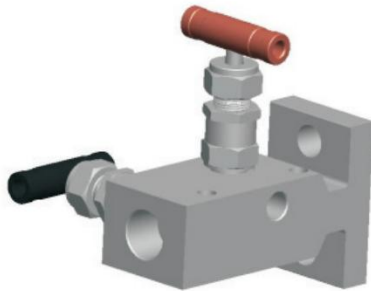
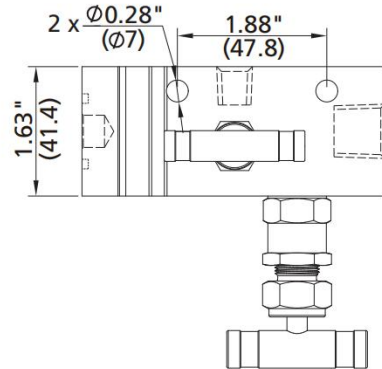
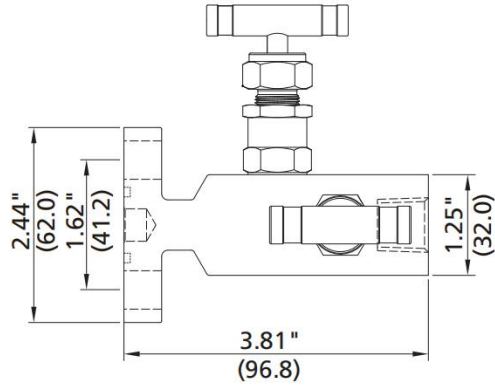

Basic Ordering NO.	Inlet/Process	Outlet/Instrument	Test/vent
SS-2M-FN8-F	1/2 Female NPT	Flange	1/4 Female NPT

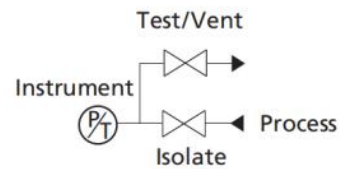
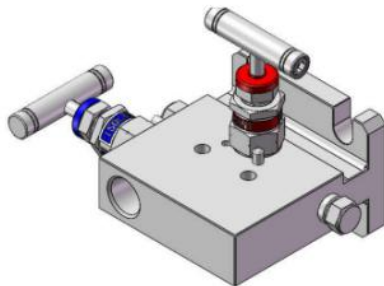
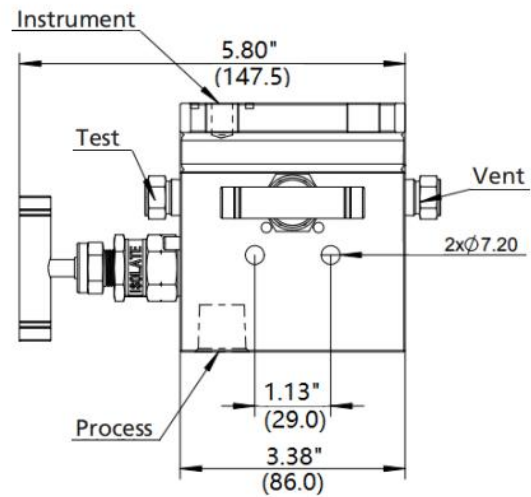
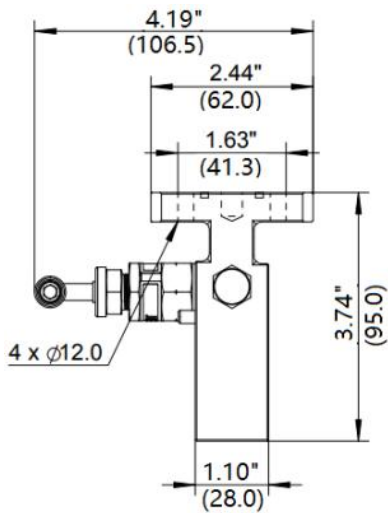

3-valve Manifolds

Consist of two block valves and one equalizer valve

Basic Ordering NO.	Inlet/Process	Outlet/Instrument
SS-3A-FN8-F	1/2 Female NPT	Flange

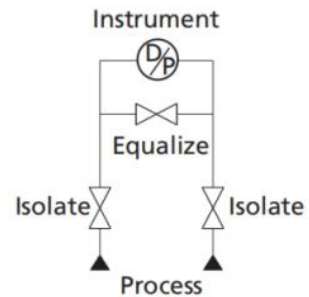
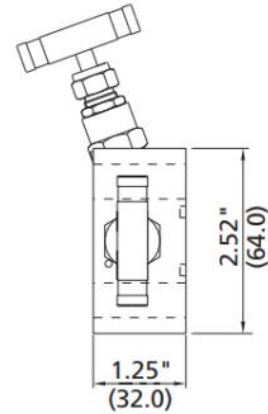
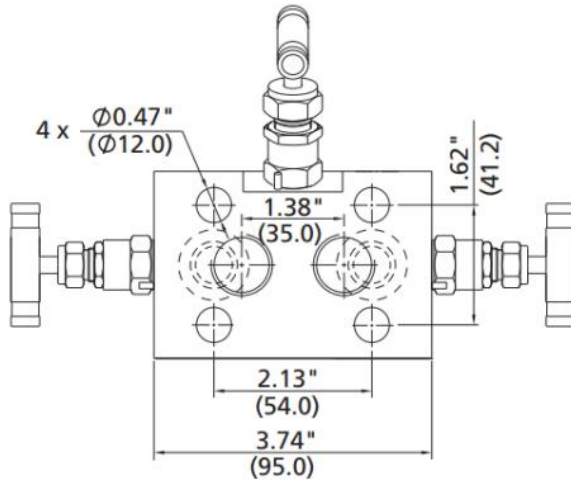

Basic Ordering NO.	Inlet/Process	Outlet/Instrument	Test/vent
SS-3B-FN8-F	1/2 Female NPT	Flange	Optional

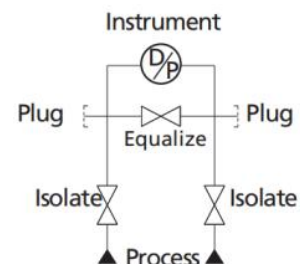
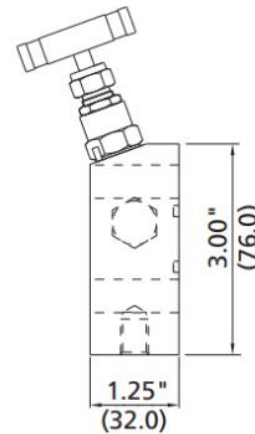
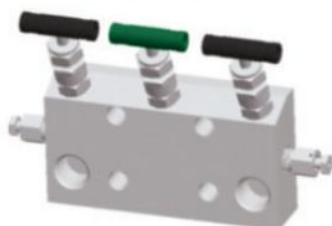
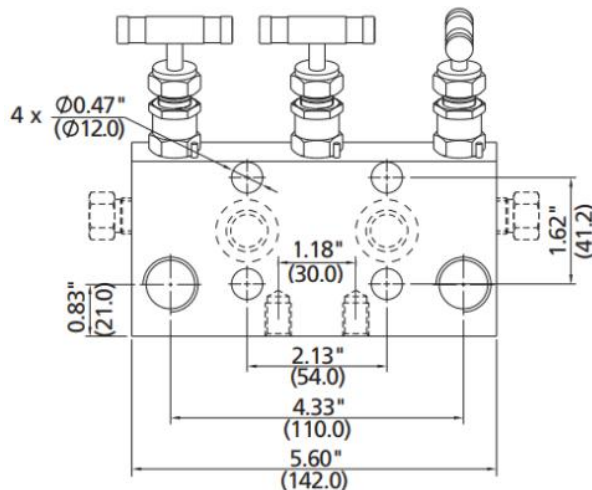

Basic Ordering NO.	Inlet/Process	Outlet/Instrument	Test/vent
SS-3C-FN8-F	1/2 Female NPT	Flange	Optional

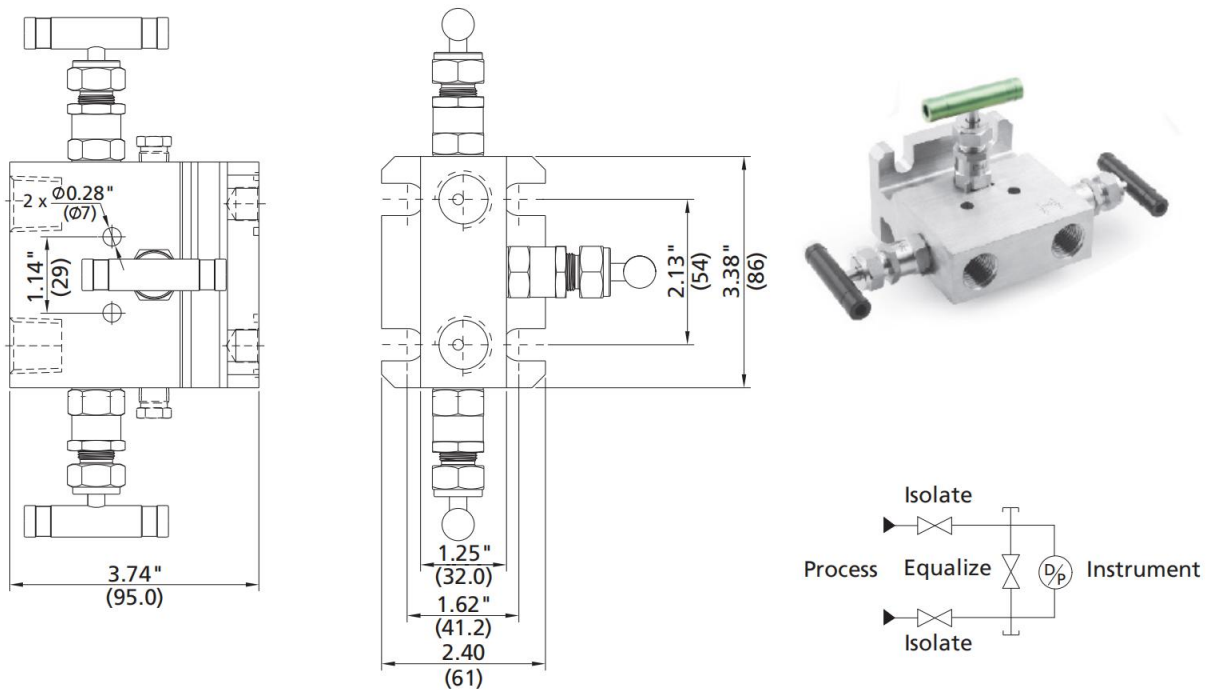

Basic Ordering NO.	Inlet/Process	Outlet/Instrument	Test/vent
SS-3D-F	Flange	Flange	Optional

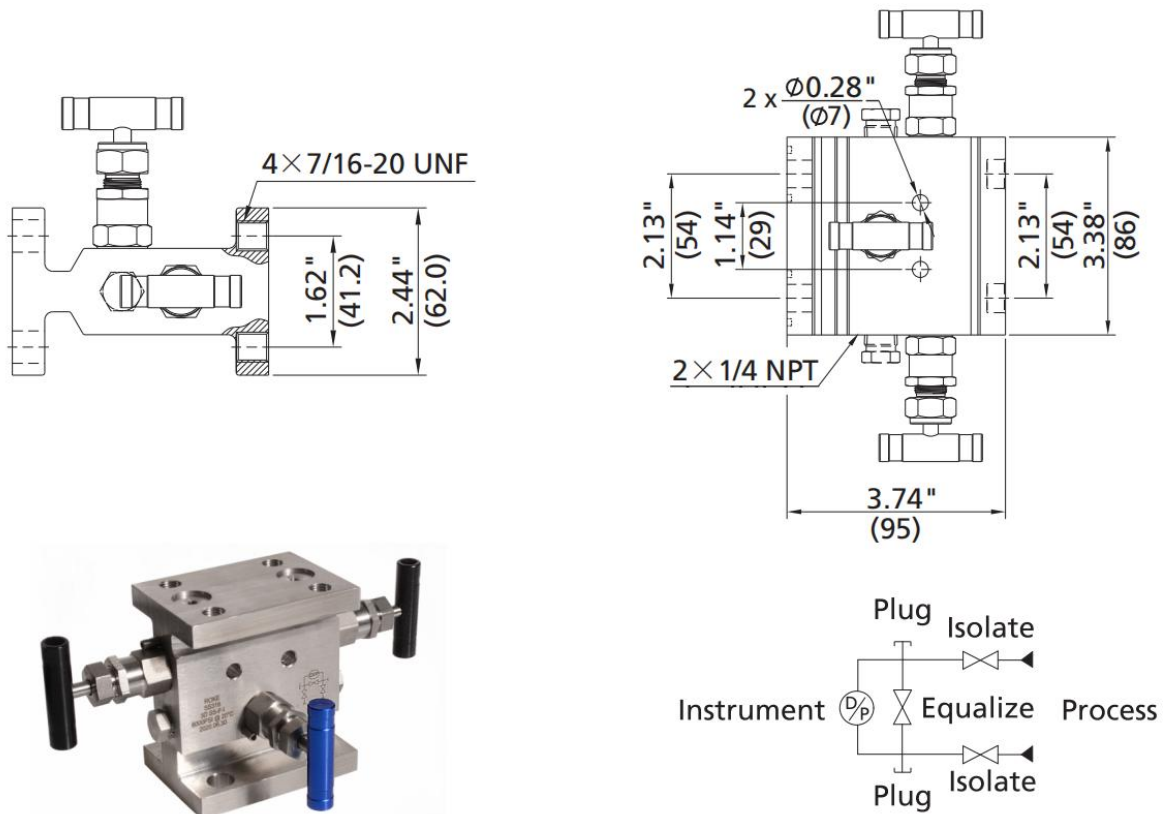

Basic Ordering NO.	Inlet/Process	Outlet/Instrument	Test/vent
SS-3E-FN8	1/2 Female NPT	1/2 Female NPT	Optional

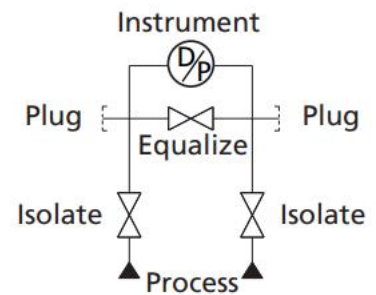
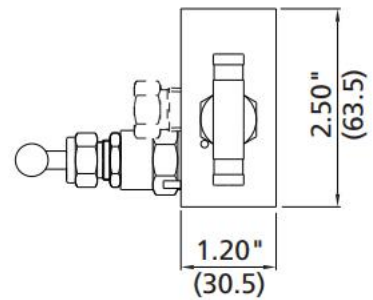
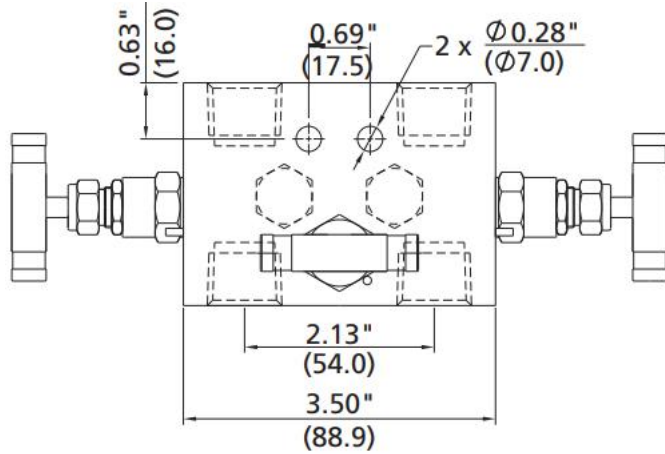

Basic Ordering NO.	Inlet/Process	Outlet/Instrument	Test/vent
SS-3F-FN8-F	1/2 Female NPT	Flange	Optional

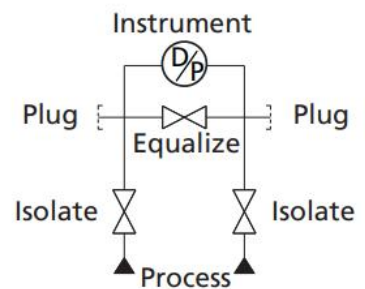
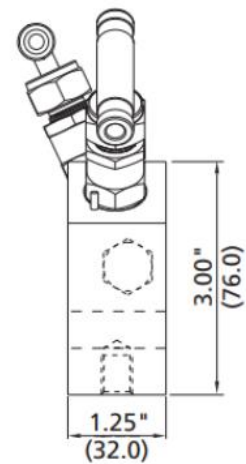
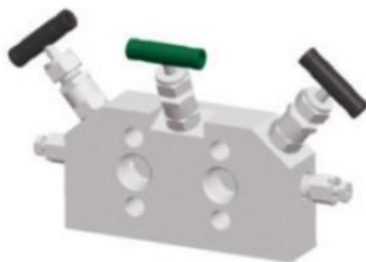
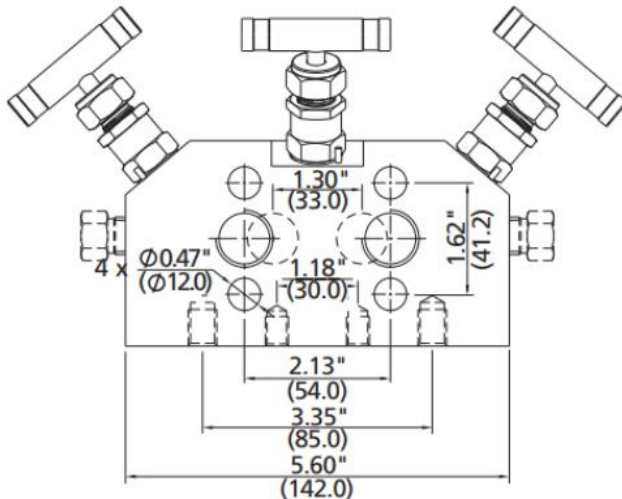

Basic Ordering NO.	Inlet/Process	Outlet/Instrument	Test/vent
SS-3G-FN8-F	1/2 Female NPT	Flange	Optional

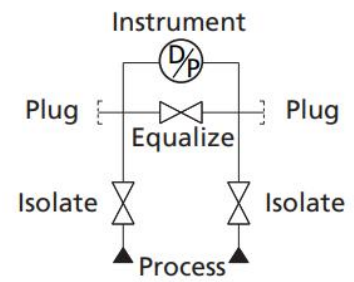
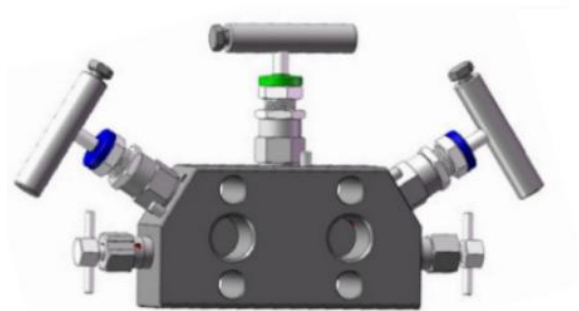
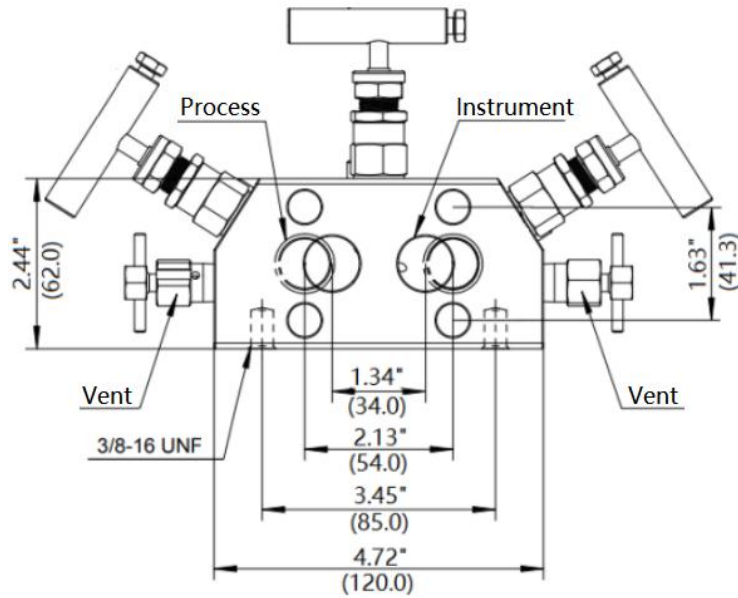

5-valve Manifolds

Double-bleed Function of 5-valve Manifold

Consist of two block valves, two bleed valves, and one equalizer valve

Basic Ordering NO.	Inlet/Process	Outlet/Instrument	Test/vent
SS-5A-FN8-F	1/2 Female NPT	Flange	1/4 Female NPT

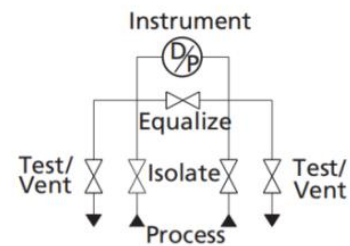
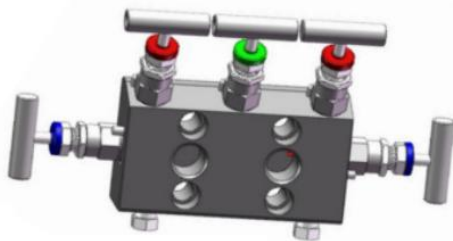
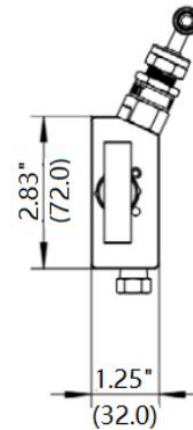
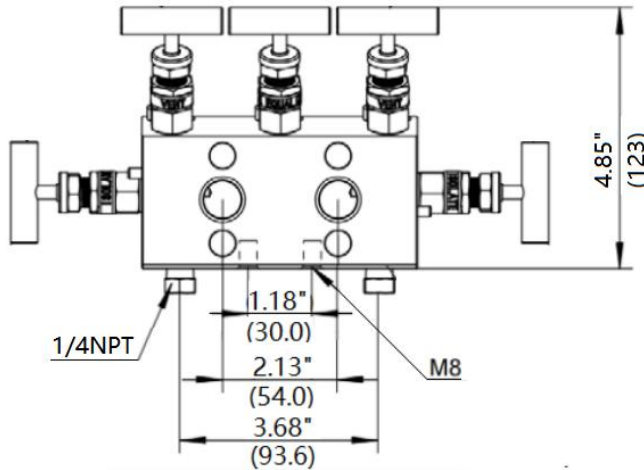

Basic Ordering NO.	Inlet/Process	Outlet/Instrument	Test/vent
SS-5B-FN8	1/2 Female NPT	1/2 Female NPT	1/4 Female NPT

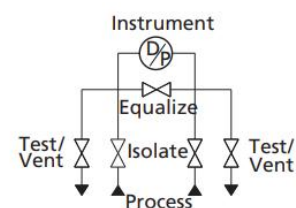
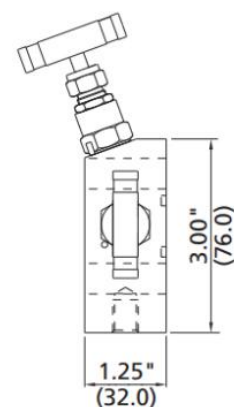
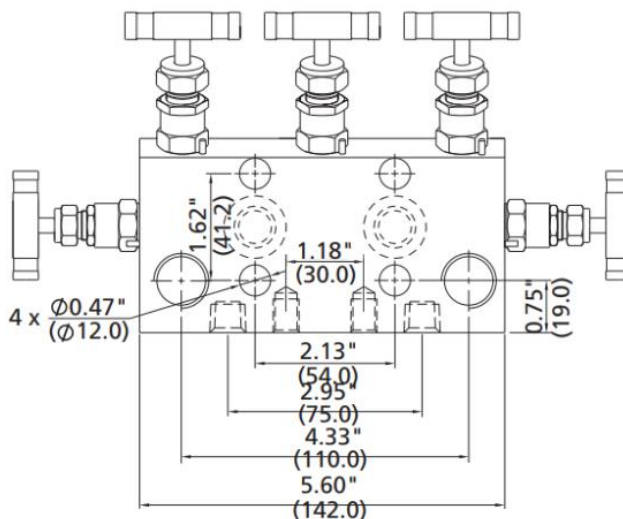

Basic Ordering NO.	Inlet/Process	Outlet/Instrument	Test/vent
SS-5C-FN8	1/2 Female NPT	1/2 Female NPT	1/4 Female NPT

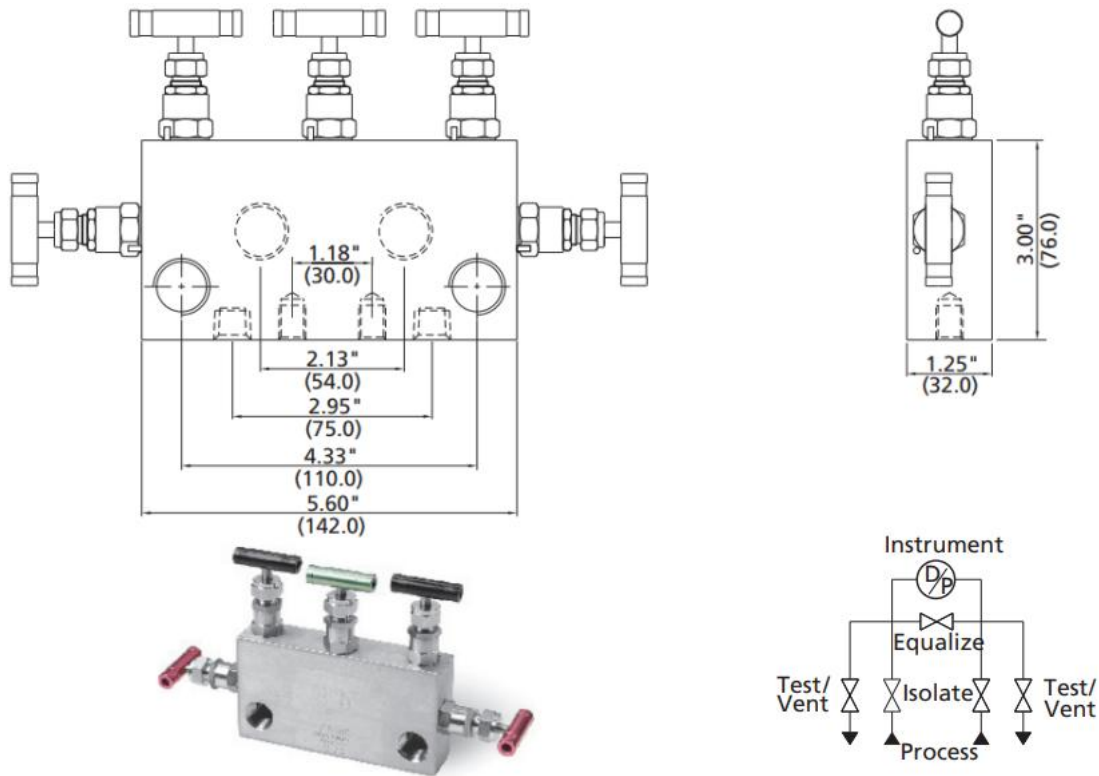

Basic Ordering NO.	Inlet/Process	Outlet/Instrument	Test/vent	Test
SS-5D-FN8	1/2 Female NPT	1/2 Female NPT	1/4 Female NPT	Optional

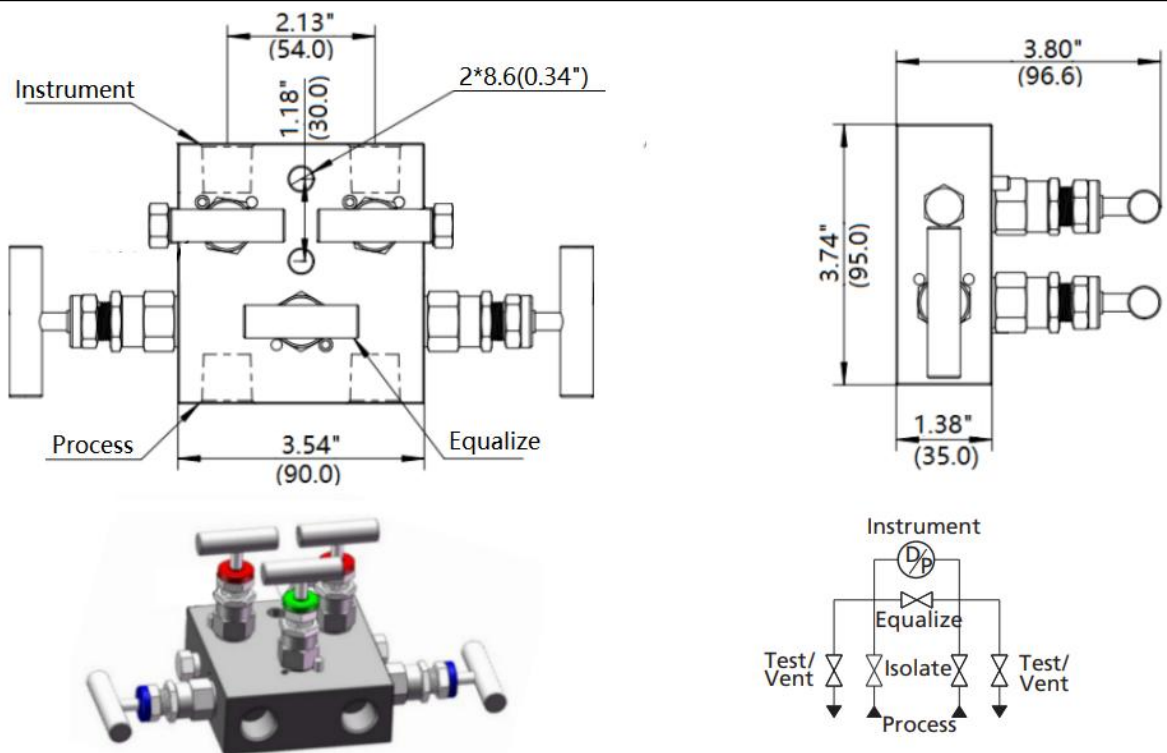

Basic Ordering NO.	Inlet/Process	Outlet/Instrument	Test/vent
SS-5E-FN8-F	1/2 Female NPT	Flange	1/4 Female NPT

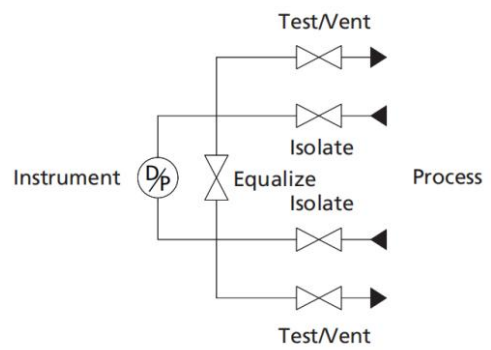
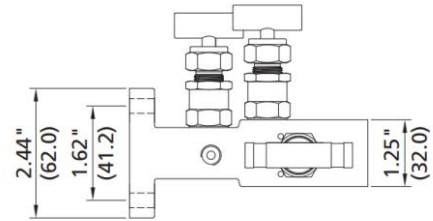
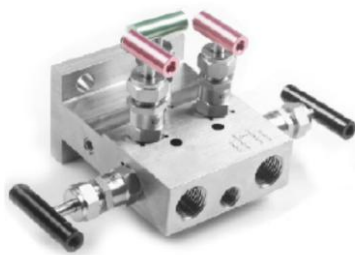
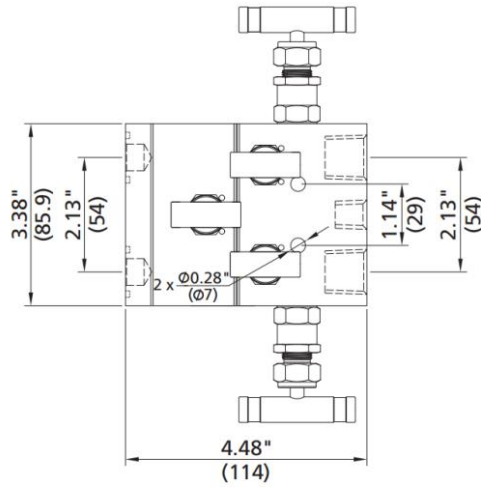

Basic Ordering NO.	Inlet/Process	Outlet/Instrument	Test/vent	Test
SS-5F-F	Flange	Flange	1/4 Female NPT	Optional

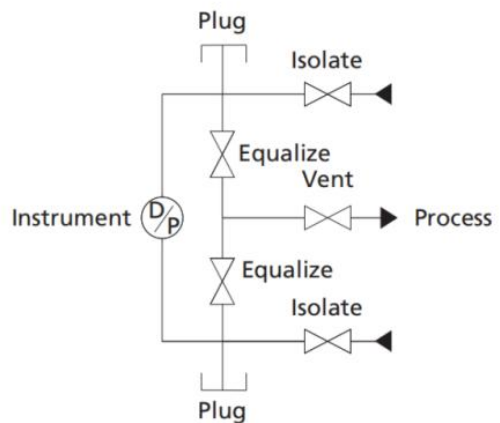
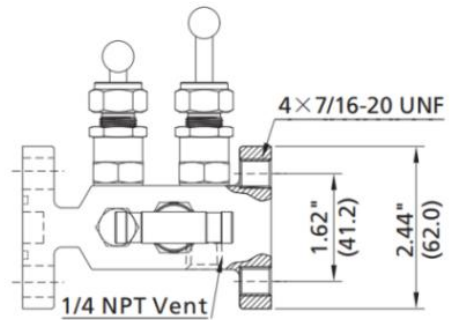
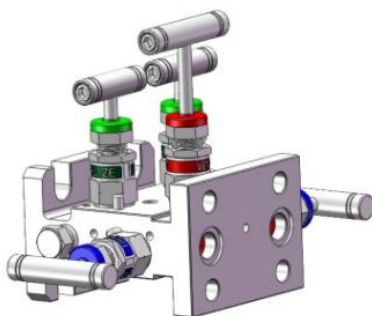
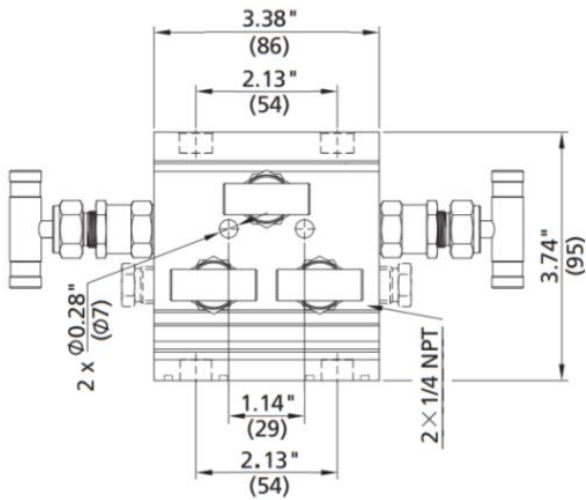

Basic Ordering NO.	Inlet/Process	Outlet/Instrument	Test/vent
SS-5G-FN8-F	1/2 Female NPT	Flange	1/4 Female NPT

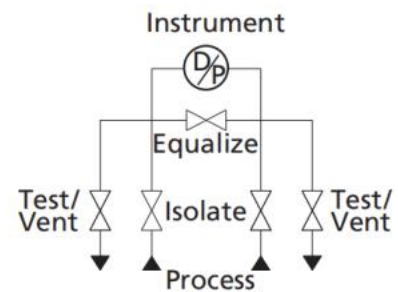
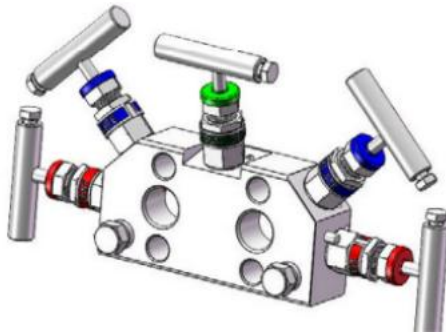
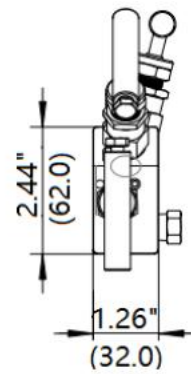
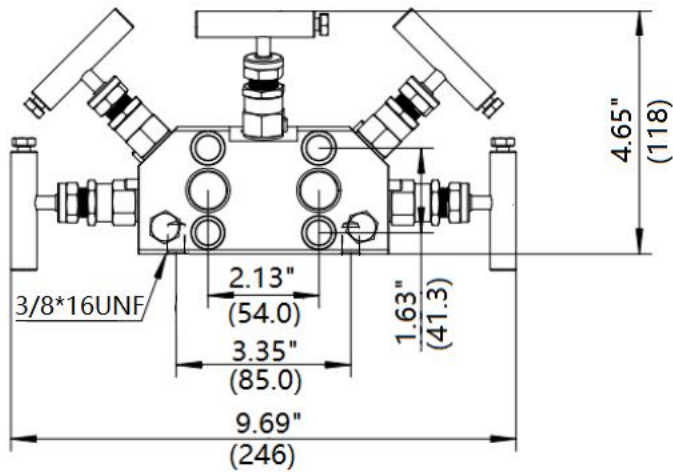

Basic Ordering NO.	Inlet/Process	Outlet/Instrument	Test/vent
SS-5H-FN8-F	1/2 Female NPT	Flange	1/4 Female NPT

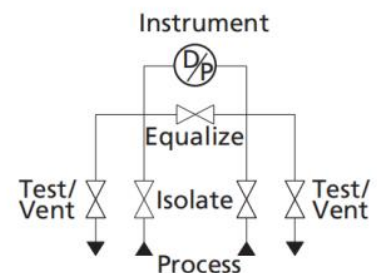
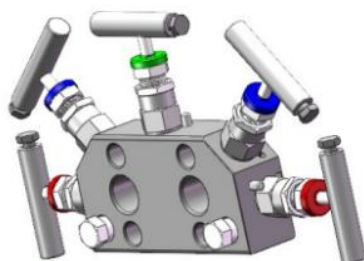
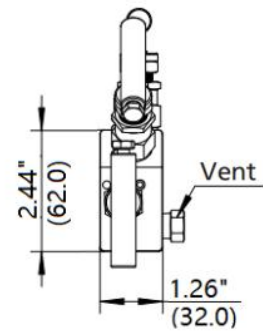
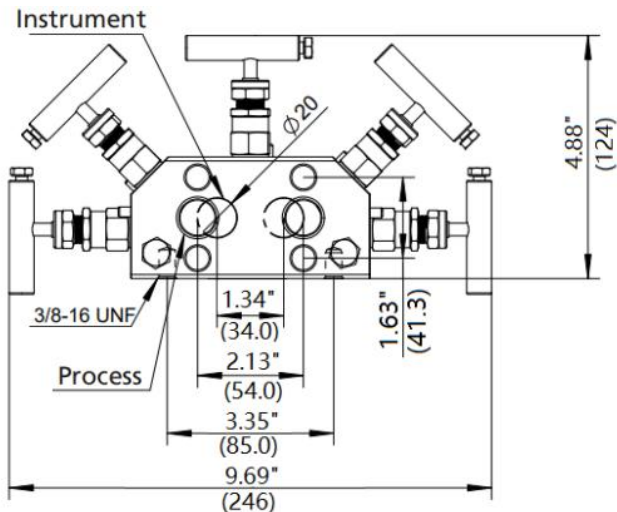

Basic Ordering NO.	Inlet/Process	Outlet/Instrument	Test/vent
SS-5J-FN8-F	1/2 Female NPT	Flange	1/4 Female NPT

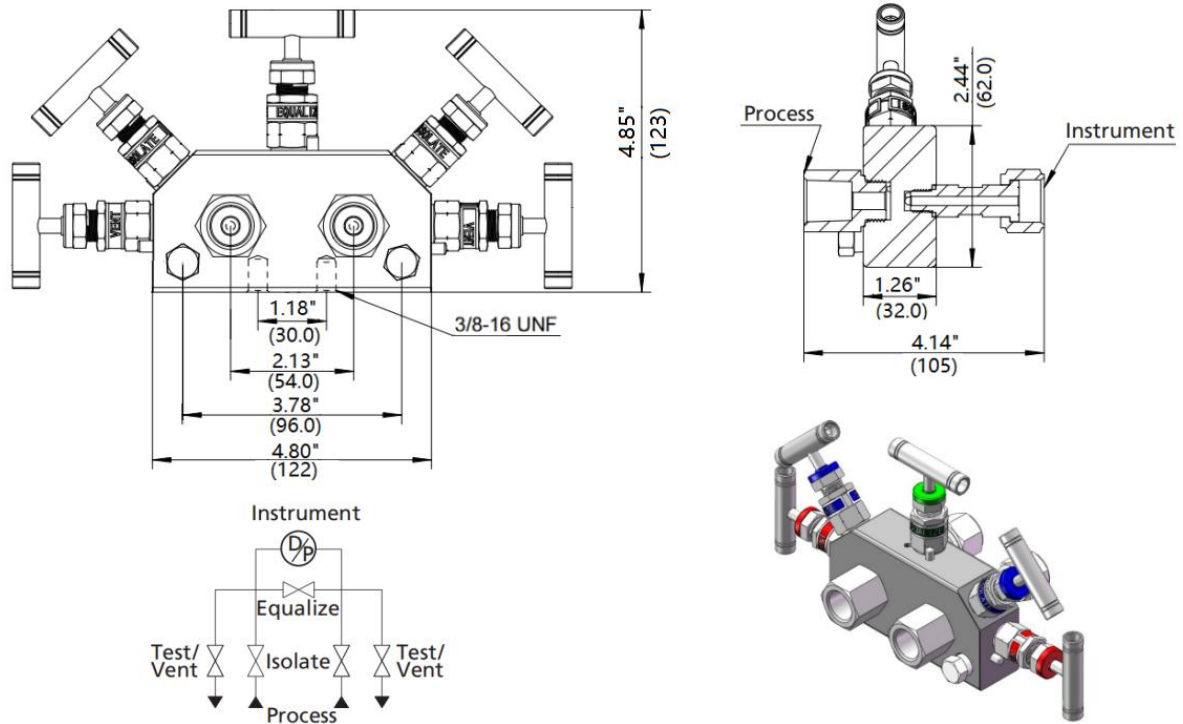

Relief Valve

- RB series RBSS-NS4 Bleed Valve is used as standard test/vent valve.
- For more information, refer to Beyond Fluid Bleed Valve RB series.

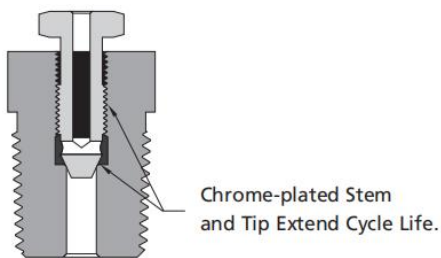

Calibration Fitting

- The calibration fittings can be connected directly with the bleed port of transmitter so that the calibration process can be simplified.
- For more information, refer to Beyond Fluid Calibration Fitting.

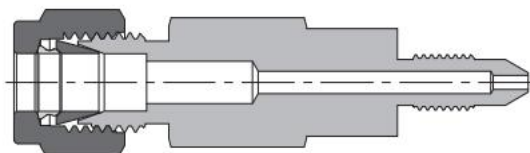

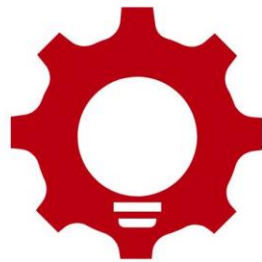

BEYOND FLUID

Beyond Fluid

E-mail: sales@beyondfluid.com

Web: www.beyondfluid.com